

企业简介 Enterprise profile

概况 Overview:

佛山市粤金海机械设备有限公司（简称：粤金海），成立于2014年，坐落于广东省佛山市南海区松夏工业园，是研发、技术服务、生产和销售一体的国家高新技术企业。

Foshan Yuejinhai Machinery Equipment Co., Ltd. (abbreviation: Yuejinhai), established in 2014, is located in Songxia Industrial Park, Nanhai District, Foshan City, Guangdong Province. It is a national high-tech enterprise integrating R&D, technical service, production and sales.

一、公司简介 Company profile:

佛山市粤金海机械设备有限公司，是一家专门从事各种铝型材阳极表面处理设备安装及铝型材自动化包装工艺的公司，我们的产品有自动喷砂机、自动贴膜机，自动绕包机、自动套袋及自动收缩机。以上产品自推出市场以来，为不少铝材厂减少了工伤，减少了人员，提高了产品质量和成品率的问题，目前已有多家大型铝材厂在使用。

Foshan Yuejinhai Machinery Equipment Co., Ltd. is the first company specializing in the installation of various aluminum profile anode surface treatment equipment and aluminum profile automatic packaging technology. Our products have automatic sand blasting machine, automatic film welding machine, automatic wrapping machine. Automatic bagging and automatic shrinking machine. Since the launch of the above products, many aluminum plants have reduced work injuries, reduced personnel, and improved product quality and yield. At present, many large aluminum plants are in use.

二、主要产品 Main products:

1、铝型材自动贴膜机 Aluminum profile automatic film welding machine

本自动贴膜机系统为本公司所发明的专利产品，具有高效节能，只需人员将型材摆放在于传输带，即可进行自行输送、自动送料、自动数膜；贴膜完成后，能自动集中于输送带上，可实现一人操控多台机子，达到节省人力的目的。

The automatic film welding machine system is a patented product invented by the company. It has high efficiency and energy saving. It only needs the personnel to place the profile on the conveyor belt, and can carry out self-feeding, automatic feeding and automatic filming. After the film is completed, it can be automatically concentrated on the film. On the conveyor belt, one person can control multiple machines to save manpower.

2、铝型材自动喷砂系统 Aluminum profile automatic sandblasting machine

本喷砂机系统为我公司所持发明专利系统，能使原来的工作量减轻劳动强度减轻，减少一半以上人员。并且具不需要更换原来的设备大大减少了投资，高效节约企业生产成本且具有全自动和半自动功能，抛丸机与喷砂一体通用。

This sand blasting machine system is the invention patent system held by our company, which can reduce the labor intensity of the original work and reduce the labor intensity by more than half. Moreover, it does not need to replace the original equipment, greatly reduces the investment, saves the production cost of the enterprise efficiently, and has the functions

of automatic and semi-automatic, and the shot blasting machine and the sandblasting are integrated.

3、型材自动套袋系统 Aluminum profile automatic bagging system

本系统为套袋和收缩一体，只需一人轻松操作就能完成自动套袋自动收缩，自动装框的一套系统，本机换型号只需 10 秒完成，套好一包只需 20 秒完成，大大减少了人员的配置和提高了效率。

The system is a combination of bagging and shrinking. It can complete the automatic shrinking of the automatic bagging with one person's easy operation. The system is automatically framed. It takes only 10 seconds to complete the model change. It takes only 20 seconds to complete a package, greatly reducing the staffing and improving efficiency.

4、挤压自动智能自动装框 Extrusion automatic and intelligent automatic frame

本系统为我公司发明的系统之一，能够自动识别型材的宽度，型材的高度，并且能够自动分析一层可装多少支型材，自动平分型材的距离，减少后面运输的碰擦伤，减少劳动强度，减少人员的配置等优点。

This system is one of the systems invented by our company. It can automatically identify the width and height of the profile, also automatically analyze how many profiles can be installed on one layer, automatically divide the distance of the profile, reduce the scratches on the back transport, reduce labor and reducing the configuration of personnel and so on.

5、型材自动绕包系统 Automatic wrapping system

本系统具有安全，方便，适应性强的特点，能够实现自动进料，自动绕包，自动捆扎，自动寻找接头，自动切断接头的特点，使用本系统后有效杜绝了工伤的特点。

The system has the characteristics of safety, convenience and adaptability. It can realize automatic feeding, automatic wrapping, automatic bundling, automatic search for joints, automatic cutting of joints, and the use of the system effectively eliminates the characteristics of work injuries.

6、阳极氧化系列 Anodizing series

我公司设计安装的阳极氧化生产线为全国效率最高的，卧式线产量最大的(最大 4000 吨/月，膜厚 15 μ m)，相同产品和质量是用电最少的 (700KW /吨)，用水量最少的 (3 吨水/吨型材)

The anodizing production line designed and installed by our company is the most efficient in the country, with the largest horizontal line output (maximum 4000 tons/month, film thickness 15 μ m), the same product and quality is the least used (700KW / ton), the least water consumption (3 tons of water / ton of profiles)

7、以上产品可根据包装工艺的需要，连城一条流水线，节能效益更可观。已有多家型材厂连接使用。

The above products can be connected to the city according to the needs of the packaging process, energy saving benefits are more impressive. A number of profile plants have been connected.

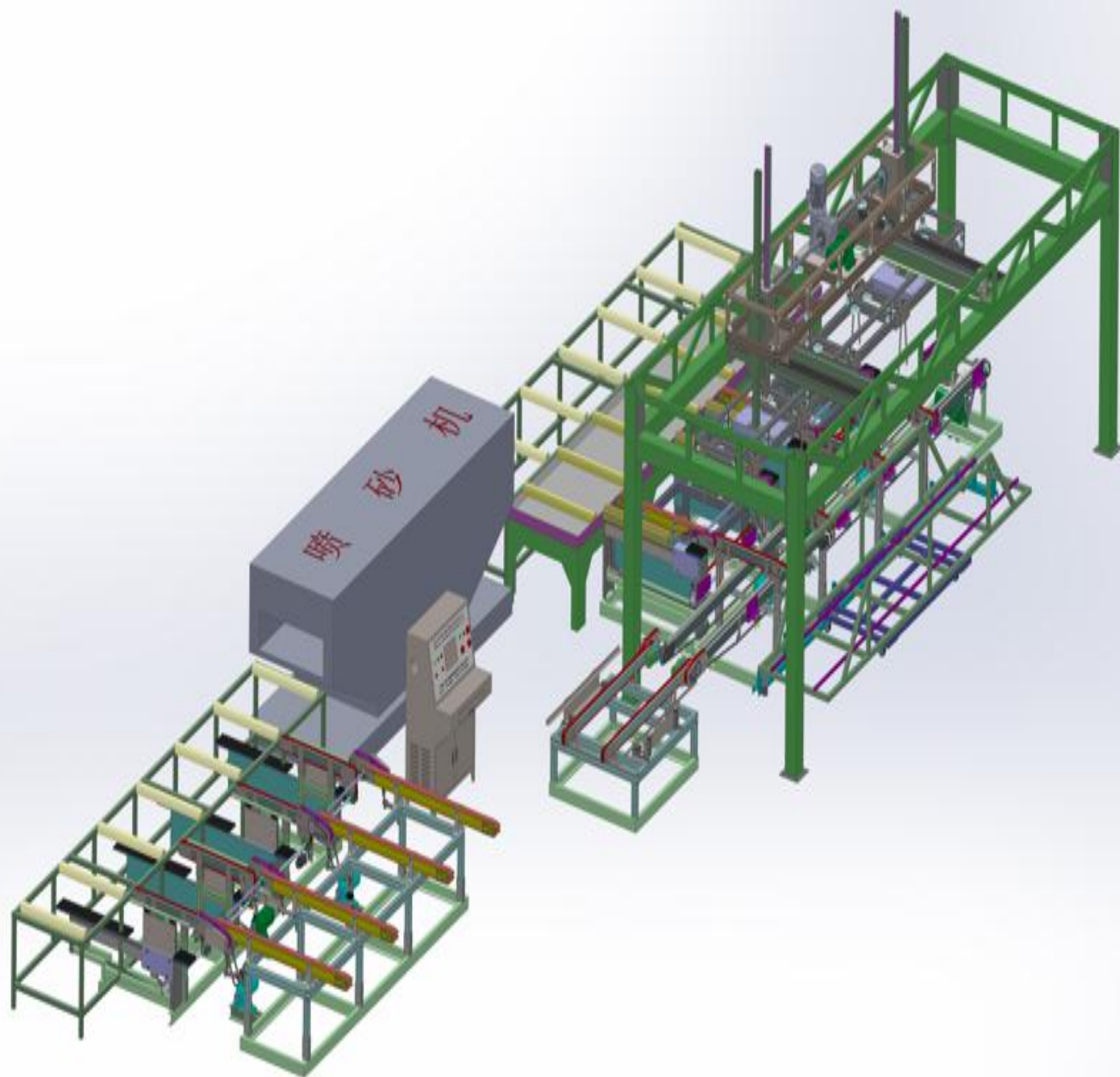

一、产品介绍 Products introduction

本喷砂机系统为我公司所持发明专利系统，能使原来的工作量减轻劳动强度减轻，减少一半以上人员。并且不需要更换原来的设备大大减少了投资，高效节约企业生产成本且具有全自动和半自动功能，抛丸机与喷砂一体通用。

This sandblasting machine system is the invention patent system held by our company, which can make the original workload reduce labor intensity and reduce more than half personnel. And the equipment does not need to replace the original equipment greatly reduced investment, efficient saving enterprise production cost and automatic and semi-automatic functions, shot blasting machine and sandblasting integrated universal.

二、技术参数 Technical parameters

品 牌 Brand : 佛山市粤金海机械 Foshan Yuejinhai Machinery

机 型 Model: 型材自动喷砂系统 Aluminum profile auto sandblasting system

专 利 号 Patent No. : ZL 2015 1 0199672.4

机型尺寸 Machine Dimension: 4m 米*18m 米

电 压 Voltage: 380V 50HZ

功 率 Power: 3KW

功 能 Function: Auto identify aluminum profile、Auto separation、Auto feeding 自动识别型材、自动分距、自动进料

产 量 Output: 500pcs/hour 支/时

优 势 Advantage: 传统5人1台机1班，本系统2人1台机1班，可实现1人2台机，须挤压自动装框 Traditional way is 5 person in charge of 1 unit of wrapping machine for 1 shift, this system is 2 people for 1 unit of wrapping machine for 1 shift, can realize 1 person 2 machine, need auto stacker after extrusion.

三、工艺流程 Processing flow

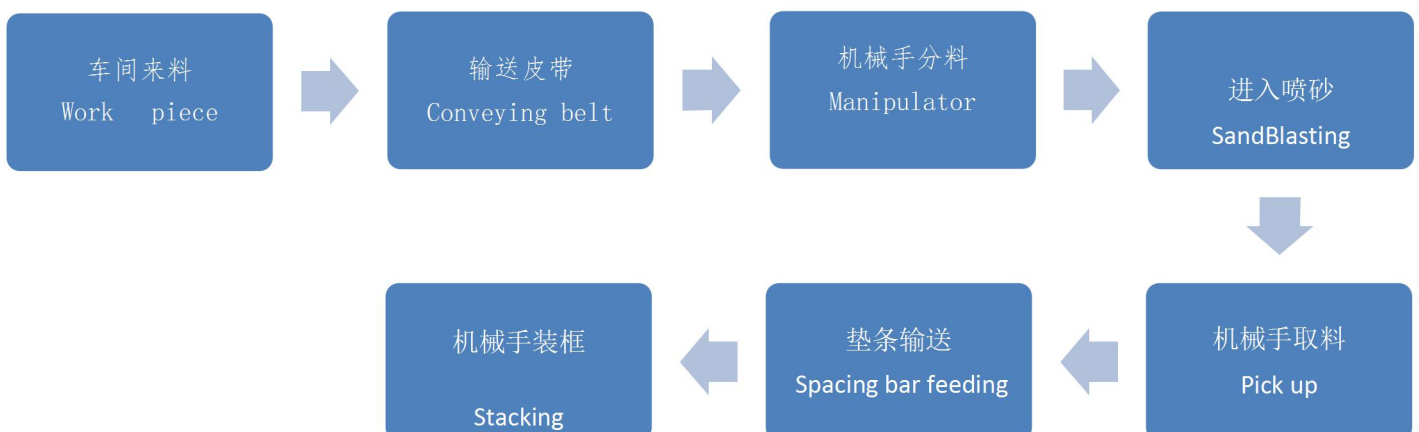

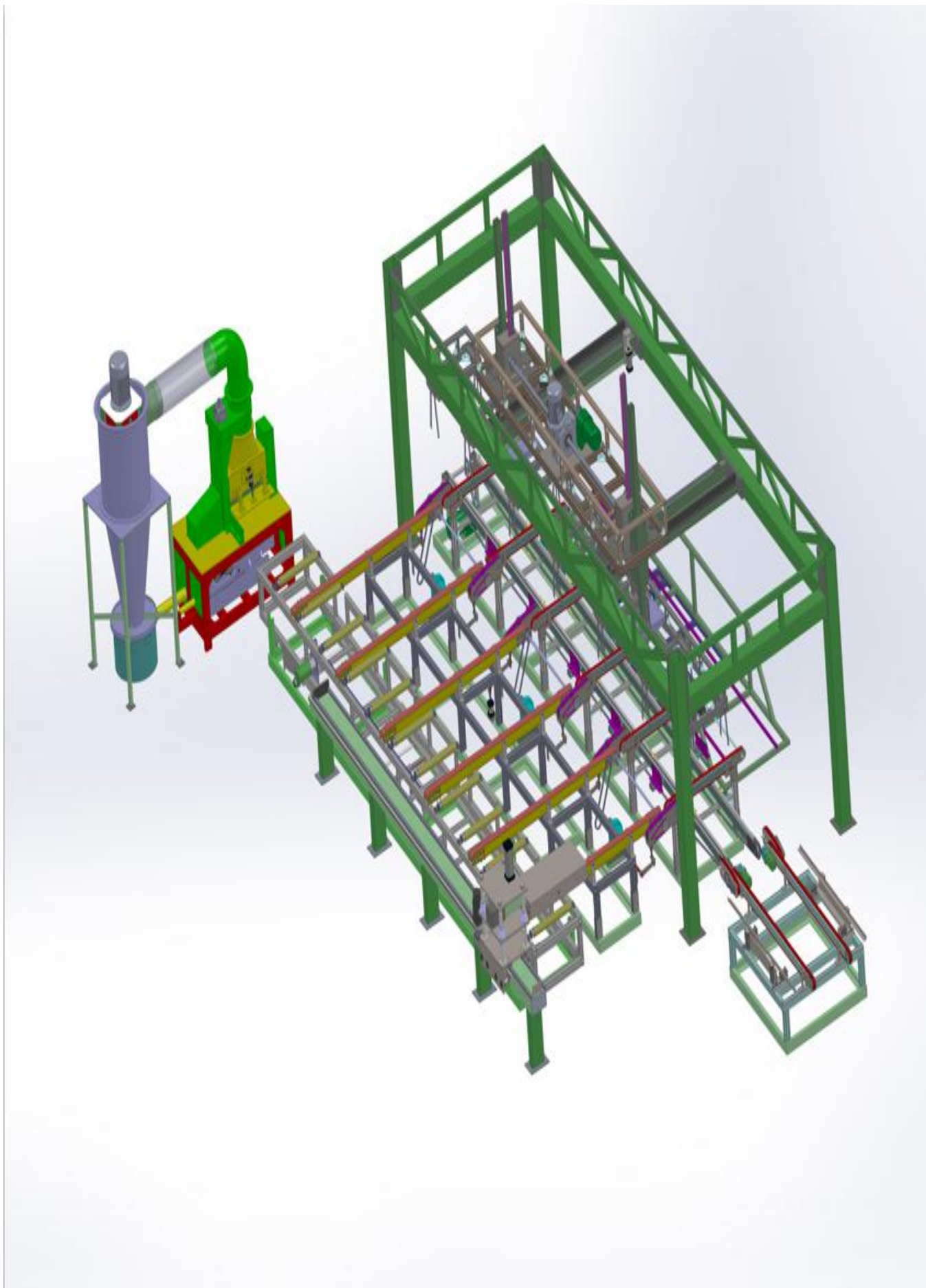

一、产品介绍 Products Introduction

本系统为我公司发明的系统之一，能够自动识别型材的宽度，型材的高度，并且能够自动分析一层可装多少支型材，自动平分型材的距离，减少后面运输的碰擦伤，减少劳动强度，减少人员的配置等优点。

This system is one of the systems invented by our company, which can automatically identify the width of profile and the height of profile, and can automatically analyze how many profiles can be installed in a layer, automatically bisect the distance of profile, reduce the bruising of the rear transport, reduce labor intensity, reduce personnel allocation and other advantages.

二、技术参数 Technical parameters

品 牌 Brand: 佛山市粤金海机械 Foshan Yuejinhai Machinery

机 型 Model: 智能挤压自动装框 Smart Stacker after Extrusion

最高速度 Highest speed: 0.512M/S (主升降 Main lift)

最高速度 Highest speed: 0.256M/S (左右行 Left and right movement)

最低速度 Lowest speed: 0.1M/S (主升降 Main lift)

最低速度 Lowest speed: 0.026M/S (左右行 Left and right movement)

最大起重 Maximum lifting load: 250KG/次 250kg/lift

单支起重 Single piece lifting load: 100KG/次 100kg/lift

最短定尺 Shortest length: 3000mm

最长定尺 Longest length: 7000mm

电 压 Voltage: 380V 50HZ

优 势 Advantage: Reduce manual operation, reduce aluminum profile scratch, reduce personnel occupational injury 减少人员操作，减少型材擦伤，减少人员工伤

对 比 Comparison: Traditional machine we need 2 people for operation, This equipment smart automatic, no need manual operation. 传统最少需 2 人操作，本设备智能自动化，无须人手

三、工艺流程 Processing flow



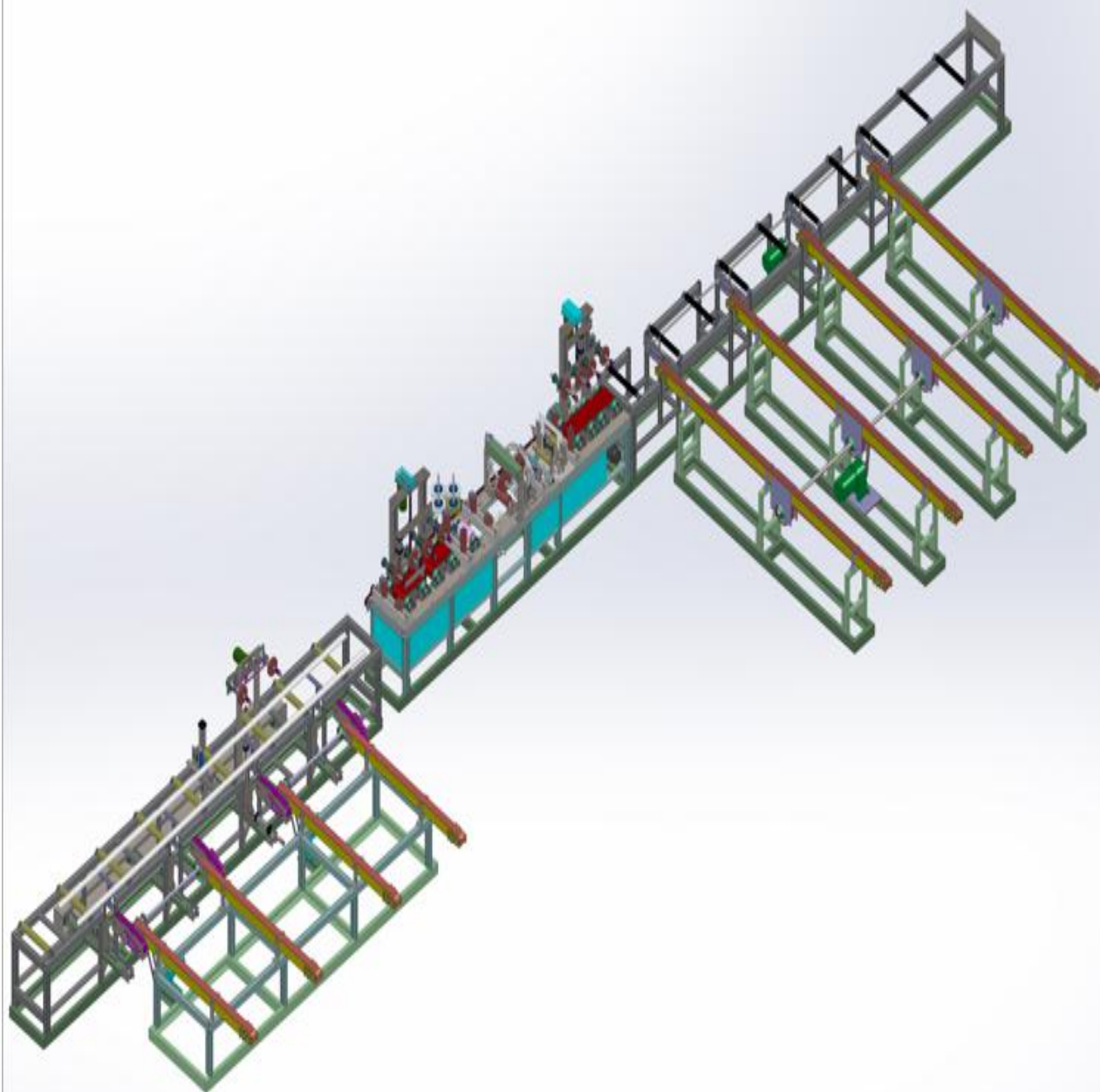

一、产品介绍 Product Introduction

本自动贴膜机系统为本公司所发明的专利产品，具有高效节能，只需人员将型材摆放于传输带，即可进行自行输送、自动送料、自动数膜；贴膜完成后，能自动集中于输送带上，可实现一人操控多台机子，达到节省人力的目的。

This automatic film sticking machine system is the patented product invented by the company. It has high efficiency and energy saving. As long as people place the profile on the transmission belt, it can carry out self-conveying, automatic feeding and automatic counting of film. After the film patch is completed, it can be automatically concentrated on the conveyor belt, and one person can control multiple machines to save manpower.

二、技术参数 Technical Parameters

品 牌 Brand: 佛山市粤金海机械 Foshan Yuejinhai Machinery

机 型 Model: 自动贴膜 Automatic Filming

专 利 号 Patent No.: ZL 2015 1 0439559.9

机型尺寸 Machine Dimension: 3m 米*18m 米

进料方式 Feeding method: 左进料/右进料 Left/Right

贴膜型材 Filming workpiece: 太阳能料/建材料 Solar/Construction materials

贴膜尺寸 Filming size: 最短 Shortest: 4m; 最长 Longest: 6.5m

贴膜规格 Filming specification: H200mm*W300mm

贴膜速度 Filming Speed: 6-10 秒/支 6-10 s/piece

电 压 Voltage: 380V 50HZ

功 率 Power: 3KW/h

耗 气 Air consumption: 1 升/次 (0.7MP 气压时)

1 litre per time (pressure 0.7mp)

功 能 Function: 自动分料、自动进入、自动识别接头、自动切断、自动出料、自动排料 Auto distribution、Auto Feeding、Auto identify joint、Auto cutting、Auto Discharge、Auto arrangement.

产 量 Output: 2500-5000 支/班 2500-5000 piece/shift.

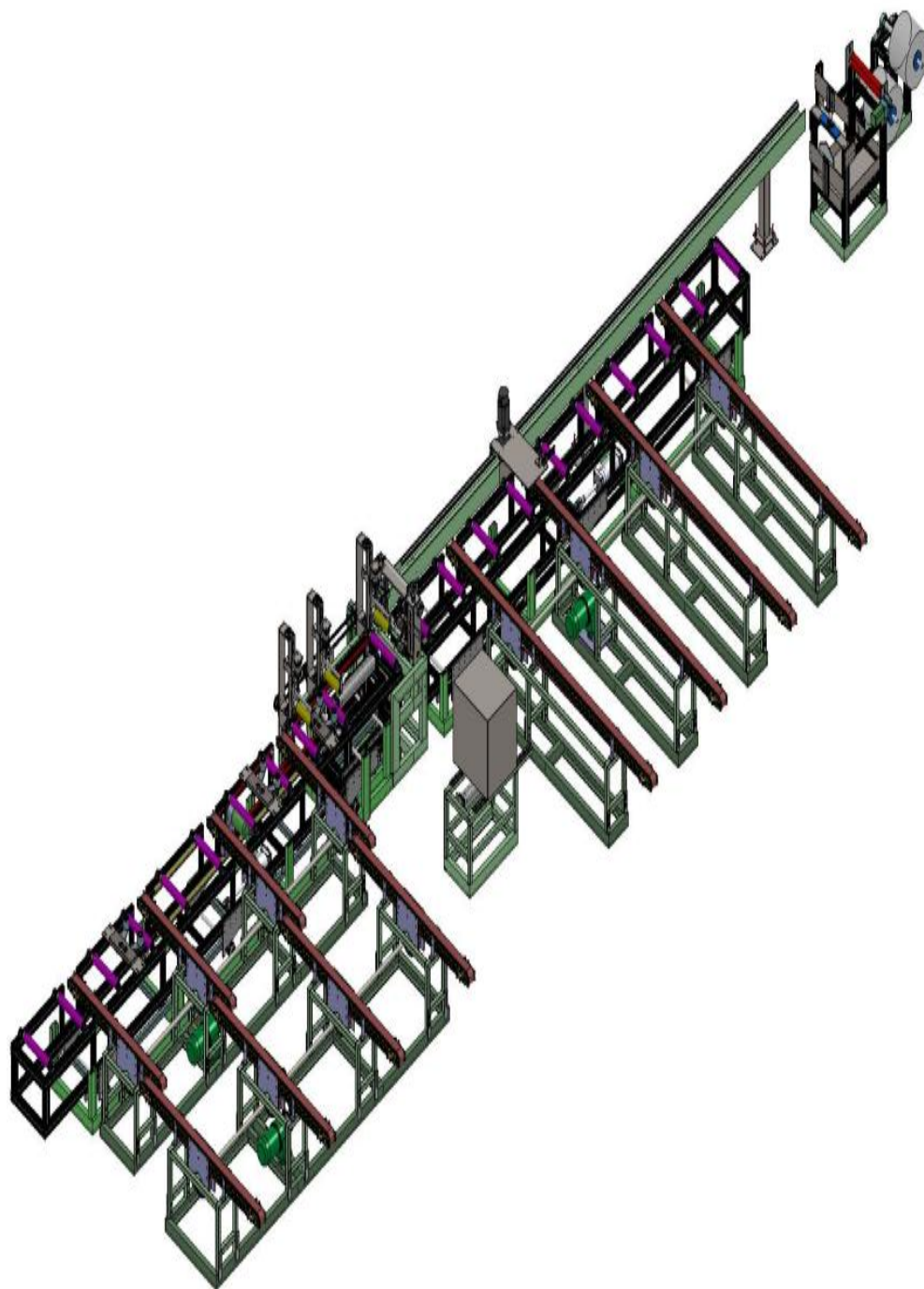

一、产品简介 Product Introduction

本系统为套袋和收缩一体，只需一人轻松操作就能完成自动套袋自动收缩，自动装框的一套系统，本机换型号只需 10 秒完成，套好一包只需 20 秒完成，大大减少了人员的配置和提高了效率。

This system is a combination of bagging and shrinking. It only needs one person to operate easily to complete the automatic bagging and shrinking. It takes only 10 seconds to change the model of this machine, and only 20 seconds to set a good package.

二、技术参数 Technical Parameters

品 牌 Brand: 佛山市粤金海机械 Foshan Yuejinhai Machinery

机 型 Model: 型材自动套袋系统 (含热收缩) Aluminum Profile Auto Bagging System(Including hot shrink)

机型尺寸 Machine Dimension: 4M 米*18M 米, 可定制 Customized is available

进料方式 Feeding method : 自动进料 Auto feeding

套袋型材 Bagging workpiece : 半自动套袋或全自动套袋

Semi auto bagging and fully automatic bagging

套袋尺寸 Bagging size: 最大 Maximum 250*200mm

套袋速度 Bagging speed : 20 秒/次 20 S/Time

电 压 Voltage: 380V 50HZ

功 率 Power: 15KW

功 能 Function: 自动套袋、自动热收缩, 换型号速度约 10 秒/次 Automatic Bagging、Automatic Hot shrinking, Exchange speed is about 10 second per time

三、工艺流程 Processing flow

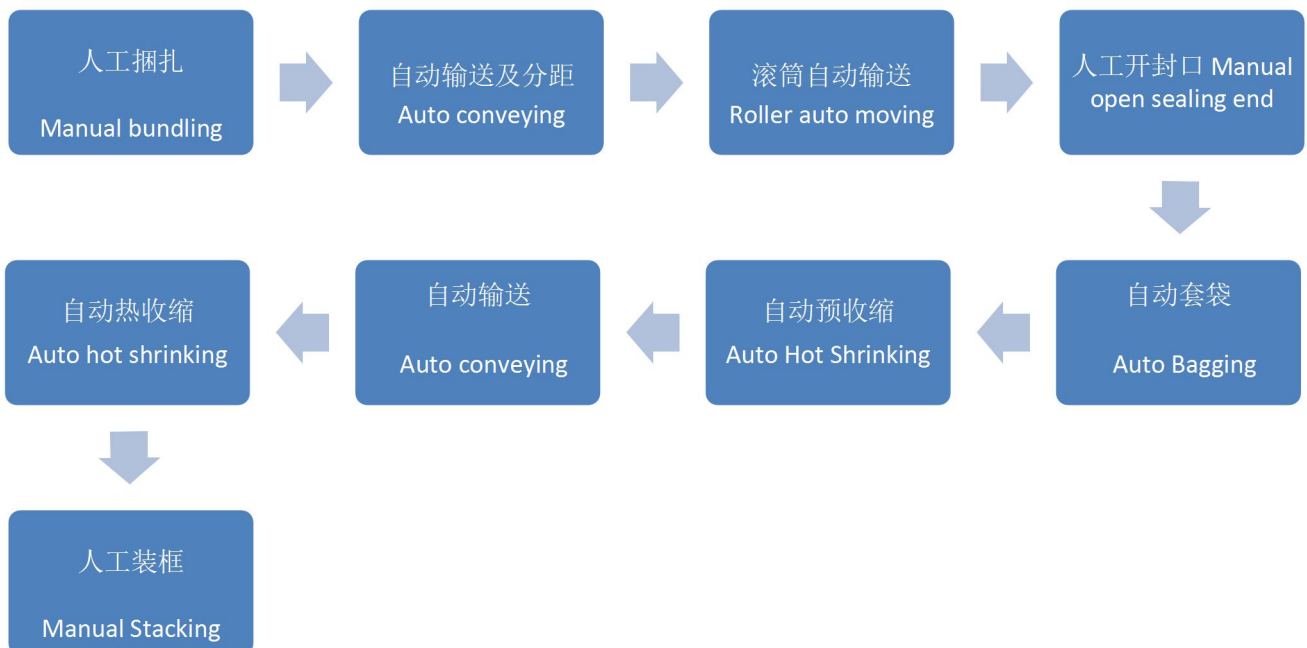

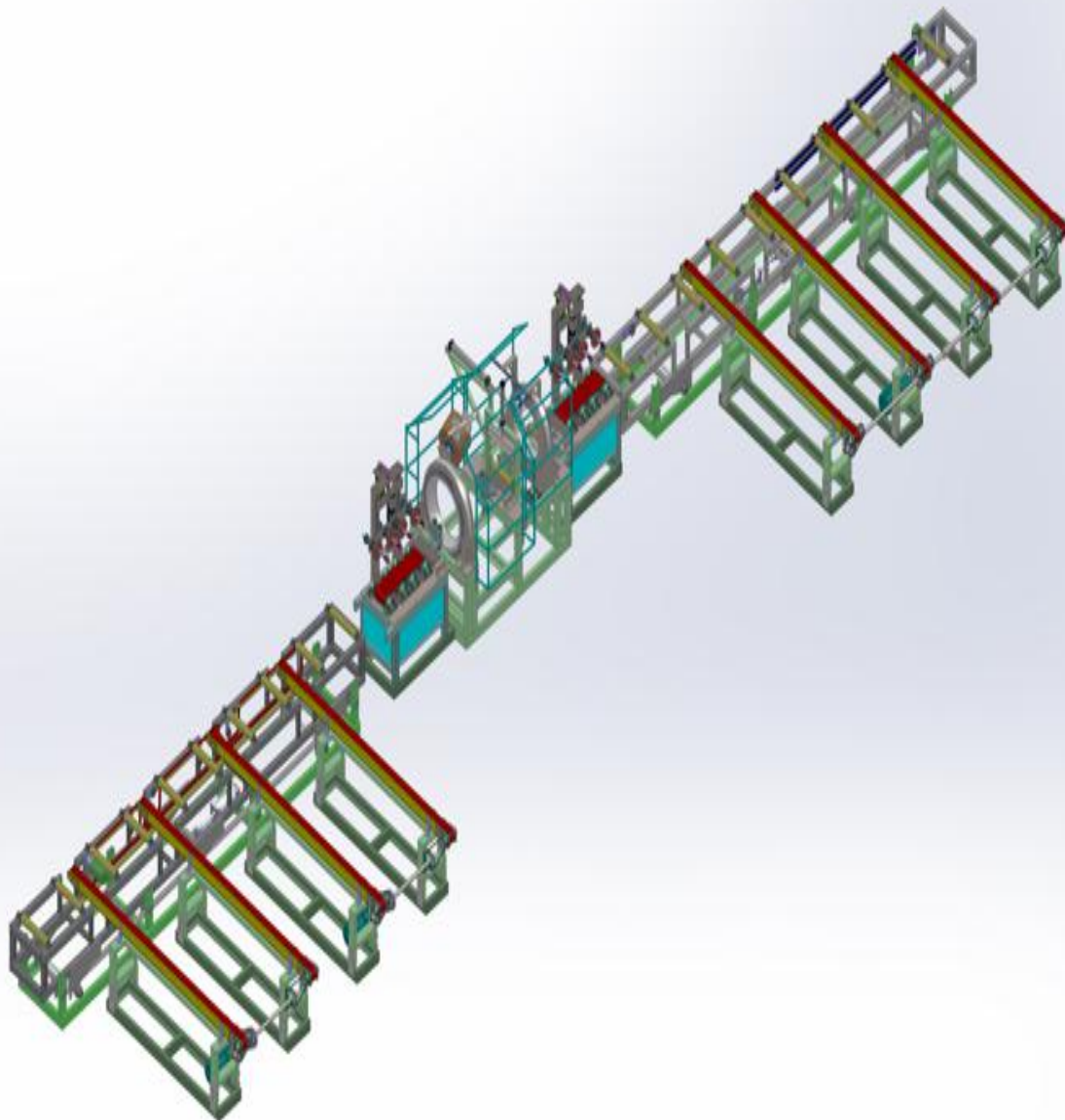

一、产品介绍 Products Introduction

本系统具有安全，方便，适应性强的特点，能够实现自动进料，自动绕包，自动捆扎，自动寻找接头，自动切断接头的特点，使用本系统后有效杜绝了工伤的特点。

This system has the characteristics of safety, convenience and strong adaptability. It can realize the features of automatic feeding, automatic wrapping, automatic binding, automatic searching and automatic cutting of joints

二、技术参数 Technical Parameters

品 牌 Brand : 佛山市粤金海机械 Foshan Yuejinhai Machinery

机 型 Model : 型材自动绕包系统 Aluminum Profile Auto Wrapping system

机型尺寸 Machine Size:

进料方式 Feeding method : 自动进料 Auto feeding

绕包型材 Wrapping Workpiece:

绕包尺寸 Wrapping size : 200*200mm

绕包规格 Wrapping specification: 750mm

绕包速度 Wrapping speed: 1-158 转/分 1-158 r/m

封口速度 Sealing speed: 50 转/分 50 r/m

运行速度 Running Speed : 2 米/秒 2m/second

电 压 Voltage: 380V 50HZ

功 率 Power: 7KW

功 能 Function: Auto feeding、Auto Wrapping、Auto cutting joint end、Auto wrapping 自动进料、自动绕包、自动切断接头、自动绕封头

产 量 Output:

三、工艺流程 Processing flow

